



CheckMate™ Lawn and Athletic Field Striping Kits

1125 Mak-Tech Dr. Suite C



Lansing, MI 48906



800.411.0150

[www.bigleaguelawns.com](http://www.bigleaguelawns.com)



## CheckMate™ Grasshopper Zero Turn Lawn Striping Kit Installation Guide

### Important

Big League Lawns, LLC warrants their products to be free of defects in material and workmanship. This warranty does not cover defects due directly or indirectly to misuse, abuse, normal wear and tear, failure to properly maintain the product or used for a purpose other than that for which it is intended. The duration of this warranty is expressly limited to one year parts and labor beginning from the date of delivery to the original customer.

The obligation of Big League Lawns, LLC is limited solely to the repair or replacement, at our option, at its factory or authorized repair agent of any part that should prove deficient. Purchaser must maintain the product under normal operating conditions at all times. Prior to operation, become familiar with the attachment and any disconnect features. This product is not intended to be used in a transport position or to be backed over curbs. When not in use, the product should be removed from the mower and transported in a safe manner. Failure to follow these instructions will void the warranty.



US Patent 6,962,039 B2, US Patent 6,993,894 B2

Congratulations on your new purchase! You are just steps away from creating a beautifully patterned lawn using your new CheckMate™ lawn striping roller. To ensure a long life of both your mower and roller, please be sure to follow the mounting recommendations within this packet.



If you should have any questions regarding the use of a particular mounting method, please do not hesitate to contact us at 800.411.0150 or via email at [sales@bigleaguelawns.com](mailto:sales@bigleaguelawns.com).

Important: If you purchased your striping kit through a 3<sup>rd</sup> party vendor and have any questions regarding your mounting options, please do not hesitate to contact us. We have a great wealth of knowledge, tips and tricks, which may be helpful. Unfortunately, when we receive purchase orders via 3<sup>rd</sup> party vendors we do not know in advance what mower the roller is being attached to.

Thank you,

Big League Lawns, LLC

**When Mowing Isn't Enough... Let it Roll!**

**US Patent 6,962,039 B2**

**US Patent 6,993,894 B2**

**FEIN 38-3198349**

### Step One: Identify Mounting Hole/Bolt

For Bolt On and Coupler Installation, use the below schematics to locate your mounting hole locations. You may have existing holes that are currently occupied by OEM bolts, or you will need to drill a new 3/8" hole on each side of your frame/engine guard to accommodate the provided Pivot Bolts.

**If you have existing bolts, you will remove them and replace with the provided pivot bolts, however existing ROPS bar bolts installed on the 100V Series will be reversed and utilized to mount.**

#### Grasshopper Zero Turn Mounting Schematics

100V Series (Reverse 5/8" ROPS bar bolt and couple to it, see coupling guide at the back of this packet)

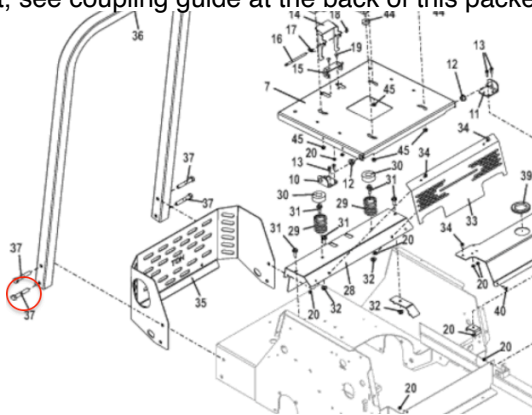

200/200V Series (Remove Bolt then Bolt on with Pivot Bolt)

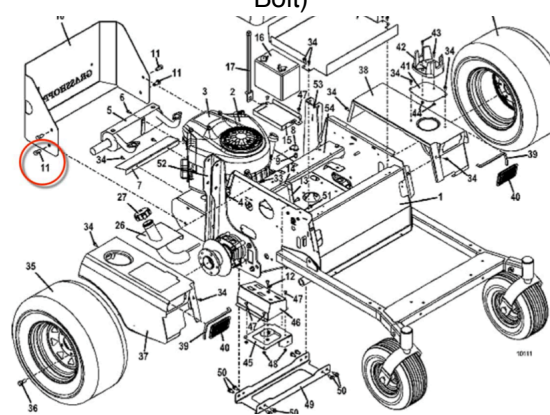

300/Diesel Series (Drill, then Bolt on with Pivot Bolt)

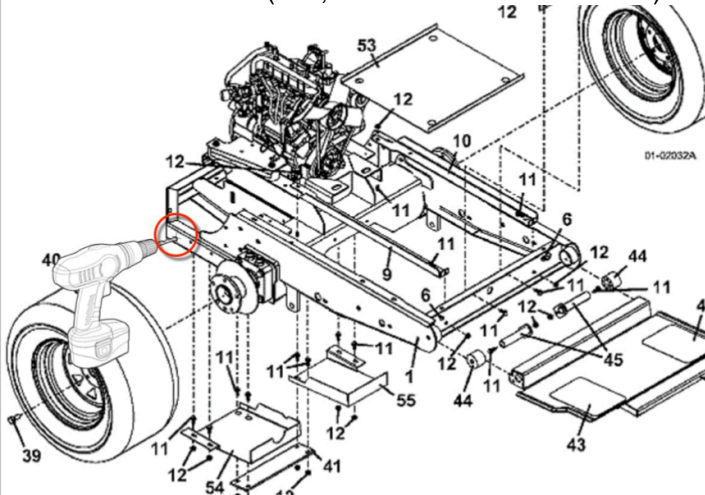

400/Diesel Series (Bolt On with Pivot Bolt)

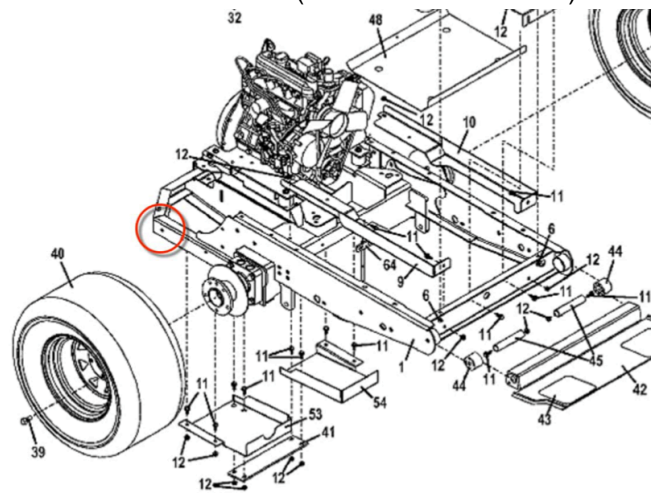



## Mounting Option D

Once your holes are located/drilled you are ready to assemble your arms and install them to your frame.

You will want to follow the schematic below to assemble your mounting arms.

[Note: Schematic shows only one of two arms you will have to assemble. Simply repeat the process for the assembly of your second mounting arm.]

**Tools Required:** For this installation you will need the following tools.



CheckMate™ Hardware



Drill  
(\*Depends on  
mower.)



3/8" Drill Bit  
(\*Depends  
on mower.)



1/8" wrench or socket  
and 3/4" wrench or  
socket

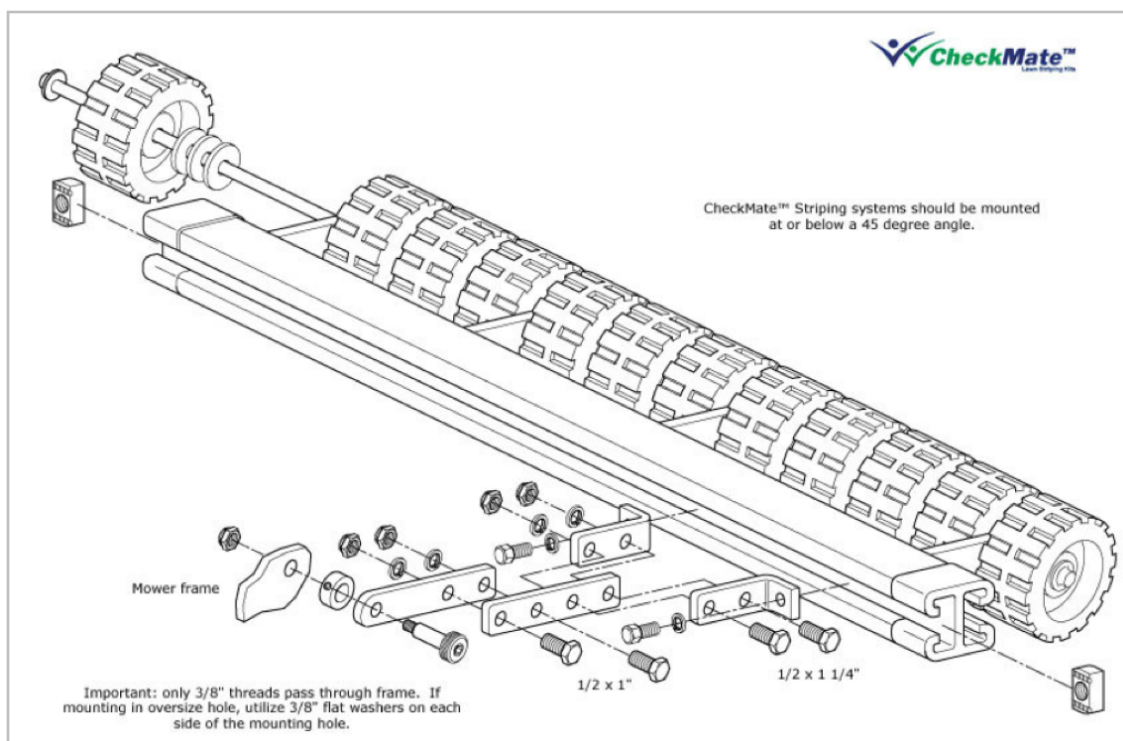



# 100V Series

## Instructions for Coupler Nut Installation

**Tools Required:** For this installation you will need the following tools.



CheckMate™ Hardware



1/8" wrench  
or socket  
and  
3/4" wrench  
or socket

Reverse your lowest ROPS bar bolts on each side of your mower, once reversed you will be able to thread the provided coupler nuts to your existing bolts. Next, thread the provided pivot bolts to the opposite side of the couplers (See guide below).

(1) Acquire Hole



(2) Install bolt



(3) Add lock washer



(4) Tighten coupler nut



(5) Thread pivot bolt



(6) Tighten pivot bolt



**Final Step For All Mounting Processes: Center the CheckMate™ behind the machine.**

Once you have the mounting arms assembled and placed on the roller, adjust the roller side to side until it is centered behind the mower. Once you have centered the CheckMate™ striping kit, you can proceed to tighten the mounting arms to the rollers gray channel/cross member.

**Scan the second QR code on the page included with your shipment to view a quick mounting arm installation tutorial.**



**Installation is now complete! Enjoy your striping with your new CheckMate™ Striping kit!**