



CheckMate™ Lawn and Athletic Field Striping Kits

1125 Mak-Tech Dr. Suite C



Lansing, MI 48906



800.411.0150

[www.bigleaguelawns.com](http://www.bigleaguelawns.com)



## CheckMate™ Dixie Chopper Stryker Lawn Striping Kit Installation Guide

### Important

Big League Lawns, LLC warrants their products to be free of defects in material and workmanship. This warranty does not cover defects due directly or indirectly to misuse, abuse, normal wear and tear, failure to properly maintain the product or used for a purpose other than that for which it is intended. The duration of this warranty is expressly limited to one year parts and labor beginning from the date of delivery to the original customer.

The obligation of Big League Lawns, LLC is limited solely to the repair or replacement, at our option, at its factory or authorized repair agent of any part that should prove deficient. Purchaser must maintain the product under normal operating conditions at all times. Prior to operation, become familiar with the attachment and any disconnect features. This product is not intended to be used in a transport position or to be backed over curbs. When not in use, the product should be removed from the mower and transported in a safe manner. Failure to follow these instructions will void the warranty.



US Patent 6,962,039 B2, US Patent 6,993,894 B2

Congratulations on your new purchase! You are just steps away from creating a beautifully patterned lawn using your new CheckMate™ lawn striping roller. To ensure a long life of both your mower and roller, please be sure to follow the mounting recommendations in this packet.

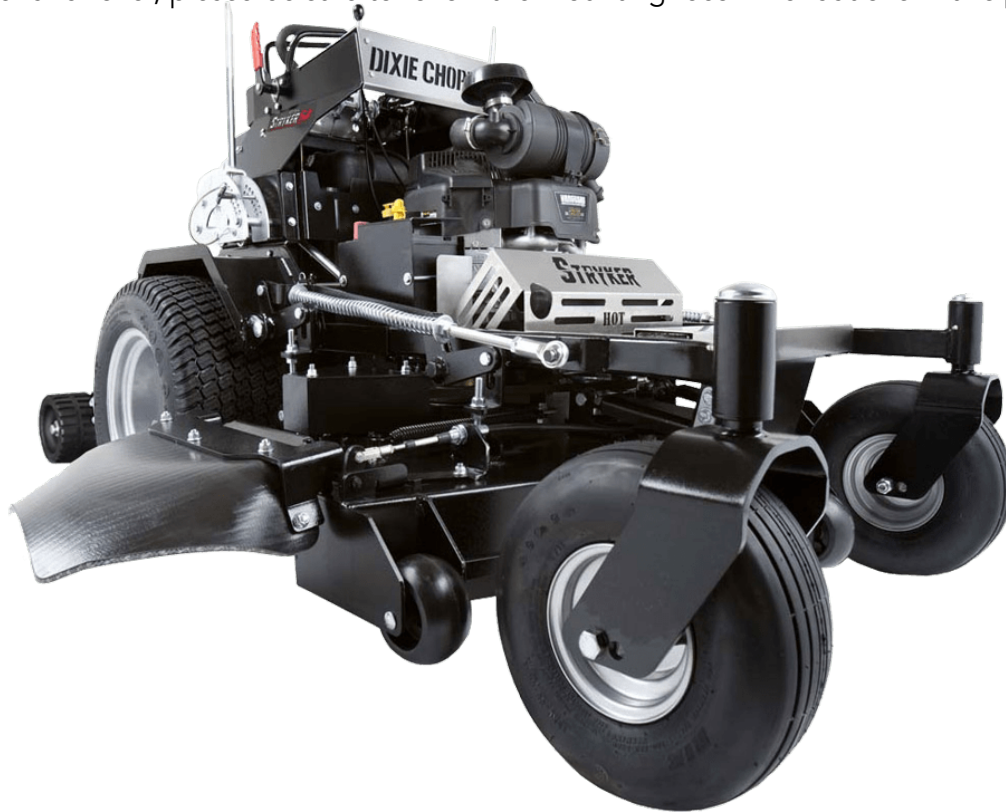

If you should have any questions regarding the use of a particular mounting method, please do not hesitate to contact us at 800.411.0150 or via email at [sales@bigleaguelawns.com](mailto:sales@bigleaguelawns.com).

Important: If you purchased your striping kit through a 3<sup>rd</sup> party vendor and have any questions regarding your mounting options, please do not hesitate to contact us. We have a great wealth of knowledge, tips and tricks, which may be helpful. Unfortunately, when we receive purchase orders via 3<sup>rd</sup> party vendors we do not know in advance what mower the roller is being attached to.

Thank you,

Big League Lawns, LLC

**When Mowing Isn't Enough... Let it Roll!**

**US Patent 6,962,039 B2**

**US Patent 6,993,894 B2**

**FEIN 38-3198349**



US Patent 6,962,039 B2, US Patent 6,993,894 B2

## Mounting Option D

*Important: Only the 3/8" threaded portion of your pivot bolt threads pass through the mower frame. If you are mounting to an oversize hole, please place a 3/8" flat washer on the pivot bolt threads to prevent the smooth portion of this bolt from passing through your frame.*

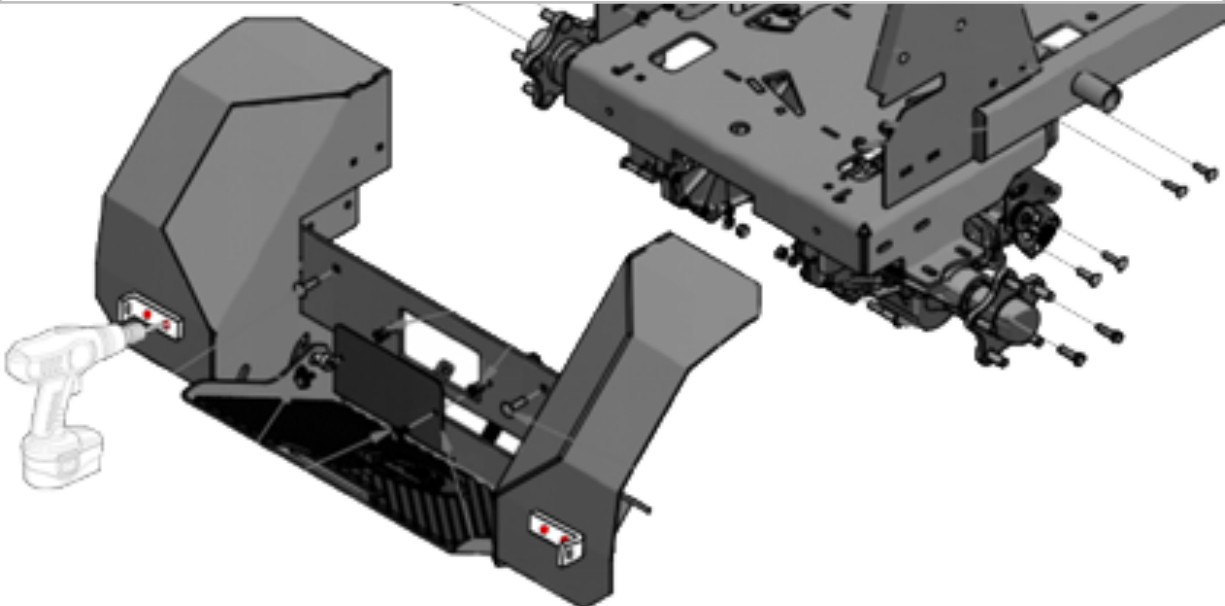
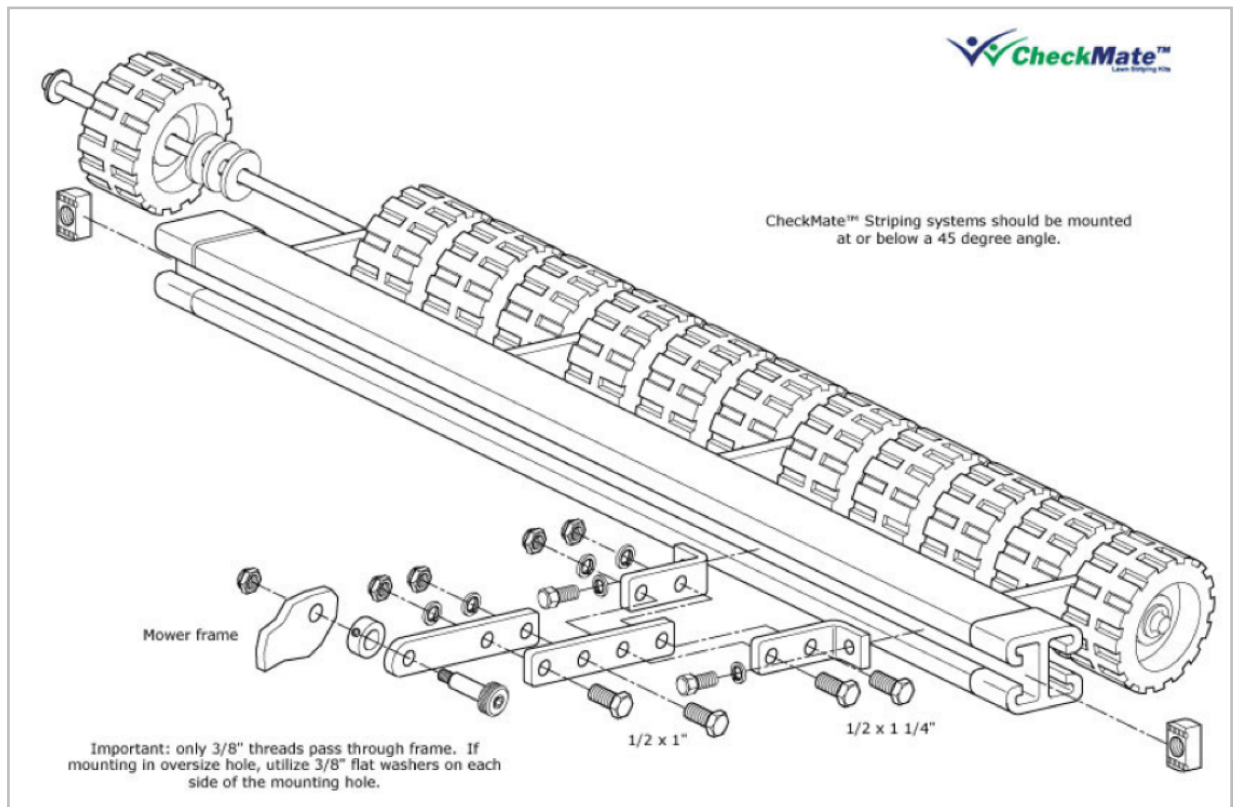





US Patent 6,962,039 B2, US Patent 6,993,894 B2

Your Dixie Chopper Stryker requires two 3/8" Holes to be drilled on each side of the standing platform. [See photos below for reference]

Line up your Quick Release L-Brackets that have stabilizer pins pre installed and mark your hole locations, then drill using a 3/8" drill bit.

It's important that these holes are drilled as symmetrically as possible to insure easy on and off quick release functionality. Stabilizer pins must be installed facing the same direction in order to allow the striper to slide on and off of the pins.

**[Note: 1. Yellow Arrows note that the quick release brackets may be reversed to accommodate smaller CheckMate™ Striping Kits.**

**Green arrows indicate that gold stabilizer pins must face the same direction, left or right.**

**2. Per mounting option D, you will need to use 4-hole extension brackets to decrease the angle in which the roller is mounted.]**

