



Mounting Instructions Cub Cadet Pro Z 100/500/700/900



Important

Big League Lawns, LLC warrants their products to be free of defects in material and workmanship. This warranty does not cover defects due directly or indirectly to misuse, abuse, normal wear and tear, failure to properly maintain the product or used for a purpose other than that for which it is intended. The duration of this warranty is expressly limited to one year parts and labor beginning from the date of delivery to the original customer.

The obligation of Big League Lawns, LLC is limited solely to the repair or replacement, at our option, at its factory or authorized repair agent of any part that should prove deficient. Purchaser must maintain the product under normal operating conditions at all times. Prior to operation, become familiar with the attachment and any disconnect features. This product is not intended to be used in a transport position or to be backed over curbs. When not in use, the product should be removed from the mower and transported in a safe manner. Failure to follow these instructions will void the warranty.



Step 1: Locate the Mounting Location

Attach the Quick Release plates to the side framing at the back of the machine. (2) 3/8" holes will need to be drilled into the machine in order to properly mount the plates. The two marked red dots below will be your mounting hole locations. **(Location Schematics on next page)**

Tools Required: For this installation you will need the following tools.



CheckMate™ Hardware



Drill
(*Depends on
mower.)



3/8" Drill Bit
(*Depends
on mower.)



1/8" wrench
or socket
and
3/4" wrench
or socket

Mounting Locations

Pro Z 100

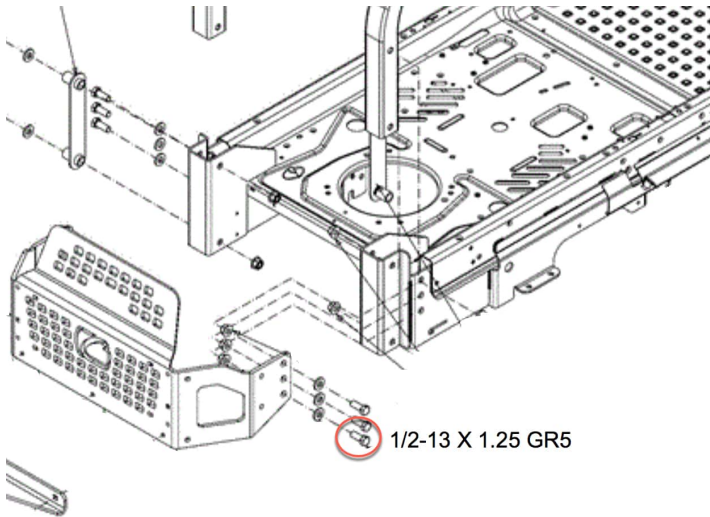

Pro Z 500/700/900

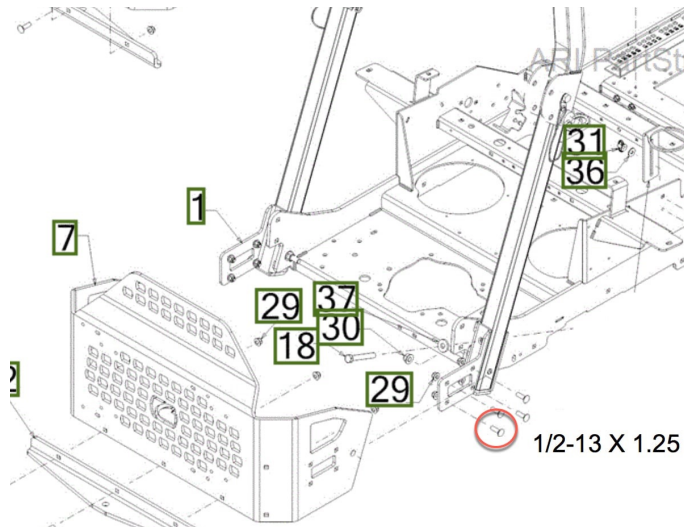

E.G. Both pins facing to the left in this example.

Step 2: Mount Plates

Use the hardware included with the Quick Release plates to attach them to the frame with newly drilled holes (3/8"). Note that when you attach the Quick Release plates, the stabilizer pins must be facing in the same direction so that the CheckMate™ striping kit will be able to properly slide on and off in the same direction.

Step 3: Assemble Hardware

Please refer to the schematic on the next page in order to assemble the mounting arms. *Note: Only finger tighten the bolts that secure the arms to the supporting channel piece for now, so that you can center the roller behind the machine before securing the arms to the channel.

Step 4: Center the CheckMate™ behind the machine.

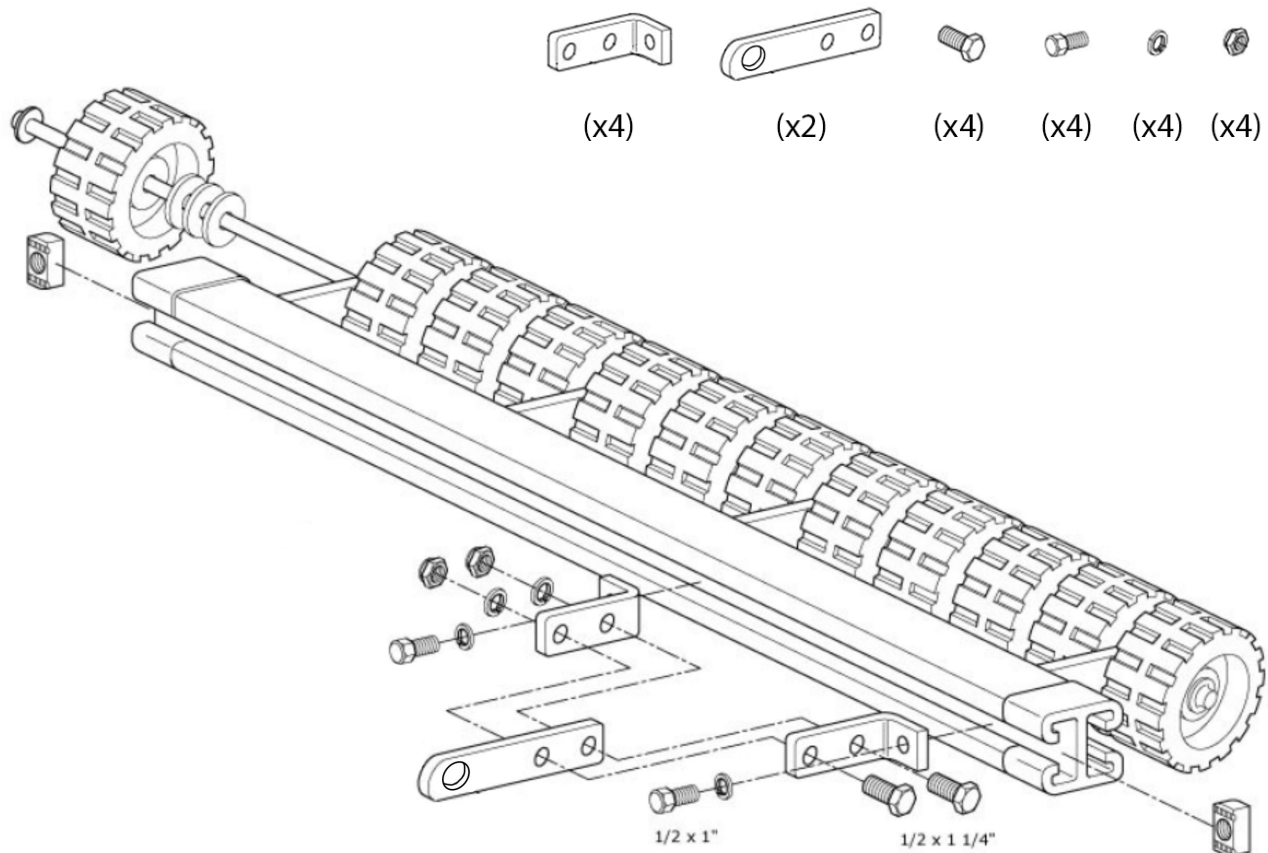

Once you have the mounting arms assembled and placed on the roller, adjust the roller side to side until it is centered behind the mower. Once you have centered the CheckMate™ striping kit, you can proceed to tighten the mounting arms to the grey channel piece.

Installation is now complete! Enjoy your striping with your new CheckMate™ Striping kit!