



CheckMate™ Lawn and Athletic Field Striping Kits

1125 Mak-Tech Dr. Suite C



Lansing, MI 48906



800.411.0150

[www.bigleaguelawns.com](http://www.bigleaguelawns.com)



## CheckMate™ Big Dog Alpha/MP/MPX | BlackJack | Diablo/MP | Stout/MP Lawn Striping Kit Installation Guide

### Important

Big League Lawns, LLC warrants their products to be free of defects in material and workmanship. This warranty does not cover defects due directly or indirectly to misuse, abuse, normal wear and tear, failure to properly maintain the product or used for a purpose other than that for which it is intended. The duration of this warranty is expressly limited to one year parts and labor beginning from the date of delivery to the original customer.

The obligation of Big League Lawns, LLC is limited solely to the repair or replacement, at our option, at its factory or authorized repair agent of any part that should prove deficient. Purchaser must maintain the product under normal operating conditions at all times. Prior to operation, become familiar with the attachment and any disconnect features. This product is not intended to be used in a transport position or to be backed over curbs. When not in use, the product should be removed from the mower and transported in a safe manner. Failure to follow these instructions will void the warranty.



Congratulations on your new purchase! You are just steps away from creating a beautifully patterned lawn using your new CheckMate™ lawn striping roller. To ensure a long life of both your mower and roller, please be sure to follow the mounting recommendations below.

**Please note the following prior to installing your new CheckMate™ Striping System:**

- All units ship with two 1/2" x 1" pivot bolts; each bolt contains 3/8" threads. Proper mounting of this bolt requires that only the threaded portion of this bolt pass through its' mounting hole. Allowing the smooth 1/2 " portion of this bolt to also pass through the hole will restrict the roller from pivoting properly.



If you should have any questions regarding the use of a particular mounting method, please do not hesitate to contact us at 800.411.0150 or via email at [sales@bigleaguelawns.com](mailto:sales@bigleaguelawns.com).

Important: If you purchased your striping kit through a 3<sup>rd</sup> party vendor and have any questions regarding your mounting options, please do not hesitate to contact us. We have a great wealth of knowledge, tips and tricks, which may be helpful. Unfortunately, when we receive purchase orders via 3<sup>rd</sup> party vendors we do not know in advance what mower the roller is being attached to.

Thank you,

Big League Lawns, LLC

**When Mowing Isn't Enough... Let it Roll!**

**US Patent 6,962,039 B2**

**US Patent 6,993,894 B2**

**FEIN 38-3198349**

Hardware Configuration:	Most Commonly Used:	Supporting Photos:
Mounting Option D	Commercial ZTR's that have existing holes on the side of their frame; Residential ZTR's such as Cub RZT, Toro TimeCutters Excel Hustler Raptors	

## Mounting Option D

Important: Only the 3/8" threaded portion of your pivot bolt threads pass through the mower frame. If you are mounting to an oversize hole, please place a 3/8" flat washer on the pivot bolt threads to prevent the smooth portion of this bolt from passing through your frame.

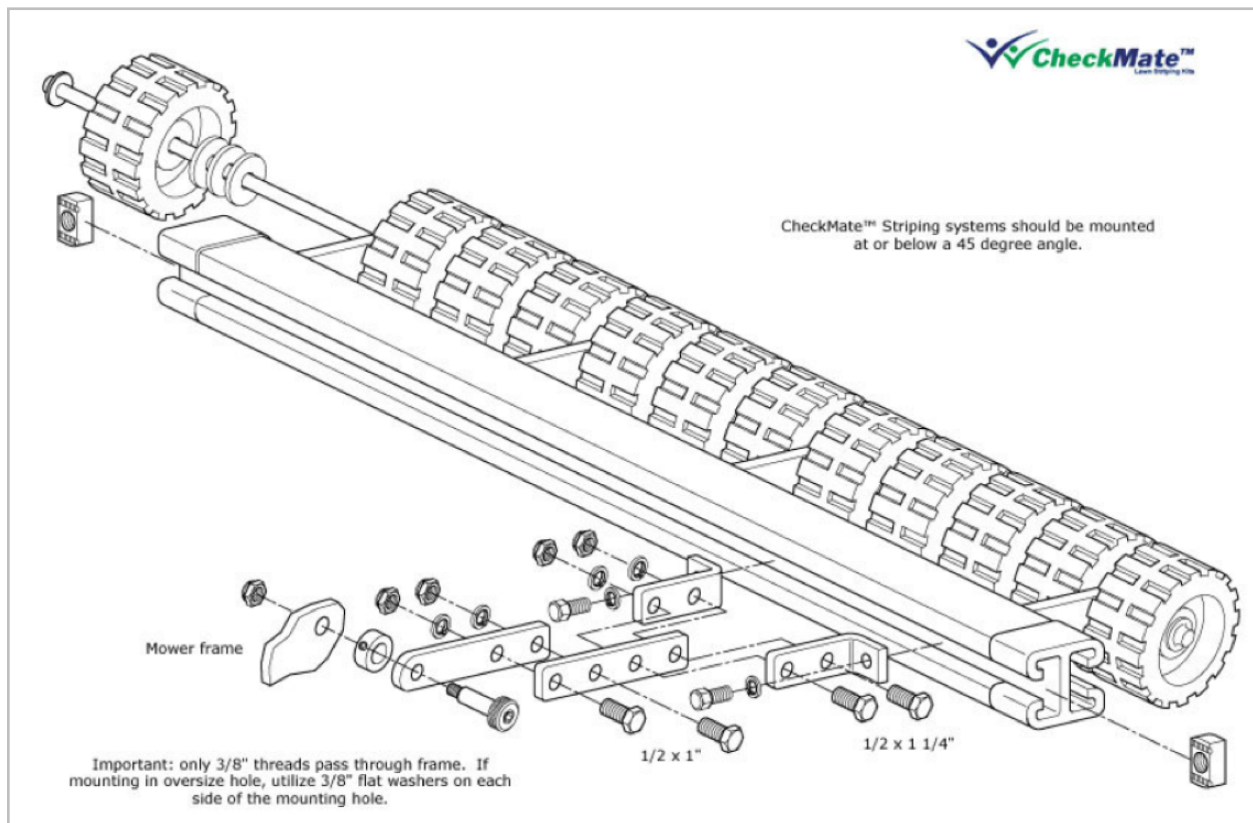





### Installation With Engine Guard:

Reverse bolt at noted location so that the threads point outward. Attach 3/8" straight "coupler nut" and secure to the frame.

Coupling Example: See Coupling Instructions on the back page of this instruction packet.

### Utilize Mounting Option D to assemble your mounting arms

\*Note: Alpha with engine guard requires a minimum of the UZTR39 striping kit size.

### Installation Without Engine Guard:

The CheckMate™ Striping kit will mount to existing holes at the rear of the machine. (Noted Location)

### Utilize Mounting Option D to assemble your mounting arms

#### Alpha + BlackJack

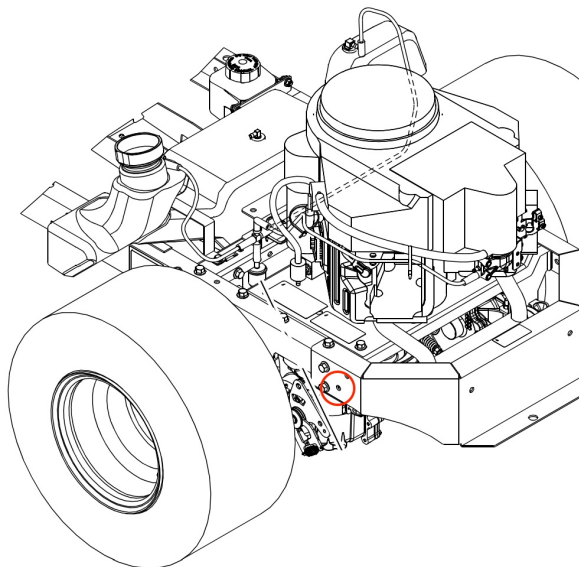

#### Diablo/MP

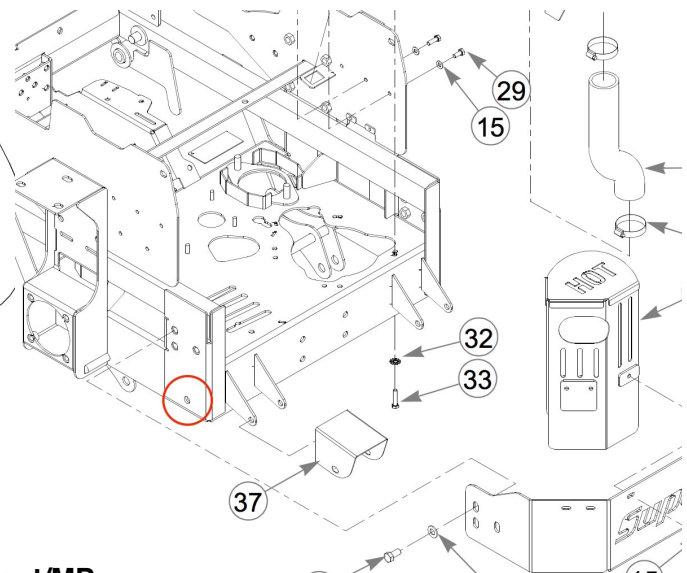

#### Stout/MP

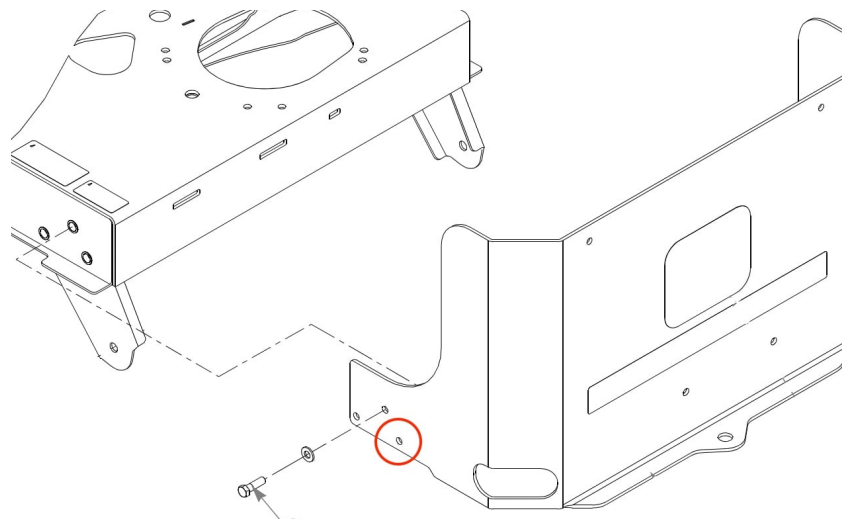



## Sample Coupling Process

Often times mowers will have existing bolts located in the side framing of the machine. If this is a bolt which we are confident we can attach the striping kit, you will find 'coupler nuts' with instructions attached to this instruction manual. The coupling process is identical for all mowers, regardless of make, model or type.

(1) Acquire Hole

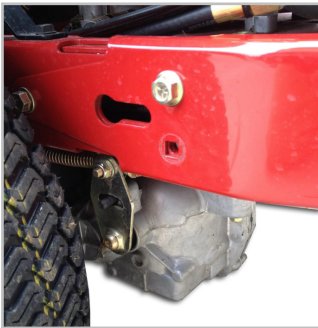

(2) Install bolt



(3) Add lock washer



(4) Tighten coupler nut



(5) Thread pivot bolt



(6) Tighten pivot bolt



**Installation is now complete! Enjoy striping with your new  
CheckMate™ Striping kit!**