



**CheckMate™ Lawn and Athletic Field Striping Kits**

1125 Mak-Tech Dr. Suite C



Lansing, MI 48820



800.411.0150

[www.bigleaguelawns.com](http://www.bigleaguelawns.com)



**CheckMate™ Lawn Striping Kit Installation Guide:  
Toro Titan HD 1500/2000/2500 | Titan Max/ Myride | 2021 Titan**

**Important**

Big League Lawns, LLC warrants their products to be free of defects in material and workmanship. This warranty does not cover defects due directly or indirectly to misuse, abuse, normal wear and tear, failure to properly maintain the product or used for a purpose other than that for which it is intended. The duration of this warranty is expressly limited to one year parts and labor beginning from the date of delivery to the original customer.

The obligation of Big League Lawns, LLC is limited solely to the repair or replacement, at our option, at its factory or authorized repair agent of any part that should prove deficient. Purchaser must maintain the product under normal operating conditions at all times. Prior to operation, become familiar with the attachment and any disconnect features. This product is not intended to be used in a transport position or to be backed over curbs. When not in use, the product should be removed from the mower and transported in a safe manner. Failure to follow these instructions will void the warranty.

## Toro Titan Schematic

**Step 1:** Identify existing  $3/8"$  x  $1"$  bolts in side of mower frame measuring  $3"$  on center and remove bolts.

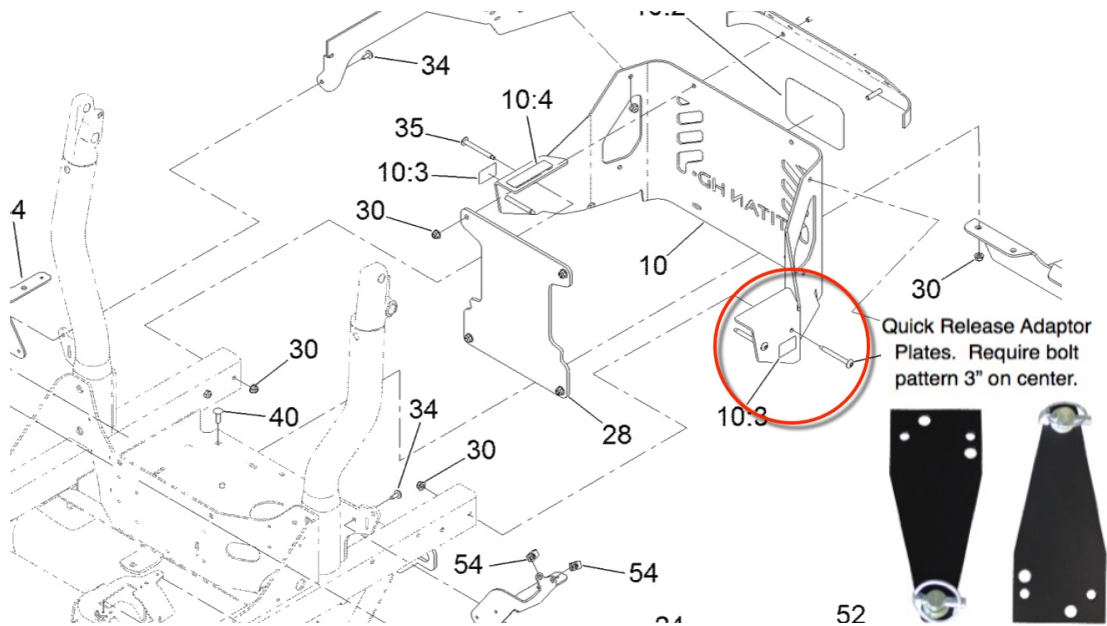

**Step 2:** Utilizing supplied  $3/8"$  x  $1\ 1/2"$  bolts, align quick release adaptor plate with existing holes/bolts in the side of the mower frame. Securely fasten adaptor plates to each side of the frame.



**Note:** Quick release pins **MUST** point in the same direction to allow the CheckMate™ Striping Kit to slide on and off from the pins. See example below:

**Step 3:** Using the supplied nuts, bolts and brackets, please configure your mounting arms as demonstrated below:

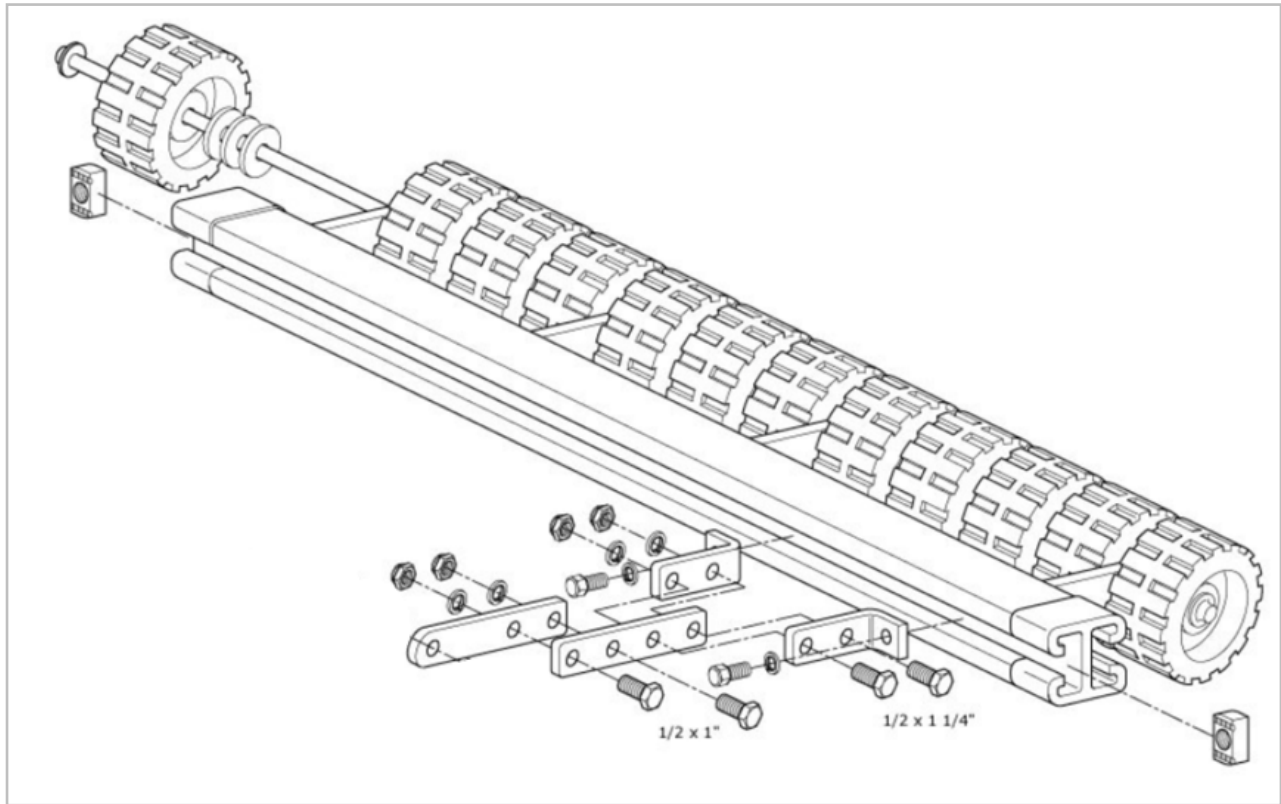

**Step 4:** Once your mounting arms are properly configured; pull the 7/16" Lynch pins from the stabilizer pins located at the bottom of your adaptor plate.

**Step 5:** Slide CheckMate™ mounting arms onto stabilizer pins and replace Lynch pins.

**Step 6:** Using (4) 1/2" x 1" hex bolts, attach mounting arms to striping kit frame [finger tight].

**Step 7:** Center the striping kit behind the mower and tighten mounting arms to striping kit frame; please apply approximately 90 lbs. torque.]

**Installation is now complete! Enjoy your striping with your new CheckMate™ Striping kit!**