



CheckMate™ Lawn and Athletic Field Striping Kits

1125 Mak-Tech Dr. Suite C.

◆ Lansing, MI 48906 ◆

800.411.0150

www.bigleaguelawns.com



CheckMate™ Lawn Striping Kit Installation Guide: Sub Compact Tractor

Important

Big League Lawns, LLC warrants their products to be free of defects in material and workmanship. This warranty does not cover defects due directly or indirectly to misuse, abuse, normal wear and tear, failure to properly maintain the product or used for a purpose other than that for which it is intended. The duration of this warranty is expressly limited to one year parts and labor beginning from the date of delivery to the original customer.

The obligation of Big League Lawns, LLC is limited solely to the repair or replacement, at our option, at its factory or authorized repair agent of any part that should prove deficient. Purchaser must maintain the product under normal operating conditions at all times. Prior to operation, become familiar with the attachment and any disconnect features. This product is not intended to be used in a transport position or to be backed over curbs. When not in use, the product should be removed from the mower and transported in a safe manner. Failure to follow these instructions will void the warranty.

Riding Mower / Frame Schematic

Step 1: Identify existing 3-Point Hitch at the rear of the tractor. This is where your striping kit will be installed to your mower. Follow the second schematic on this page to see how your installation will

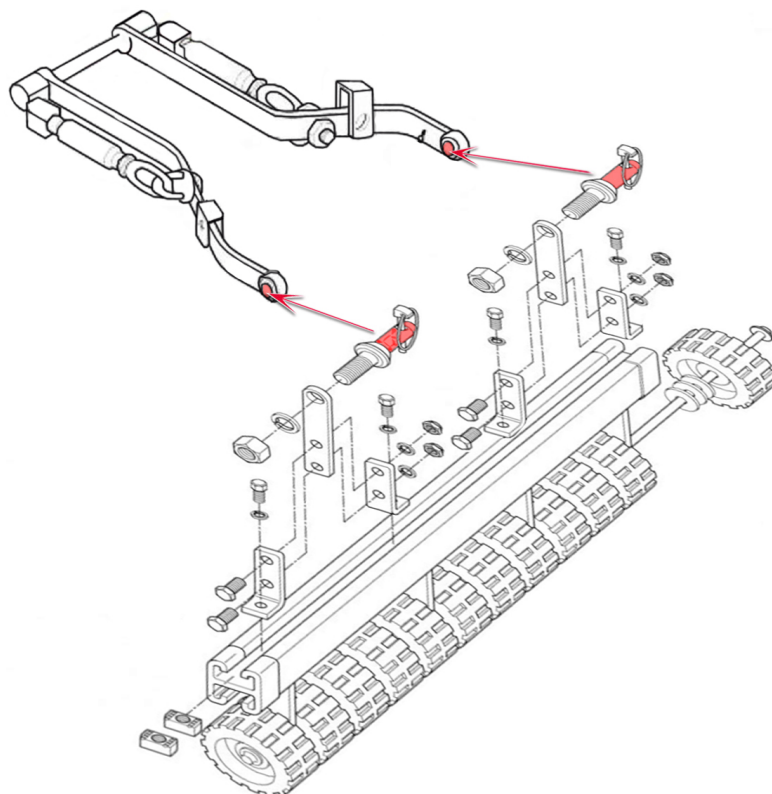
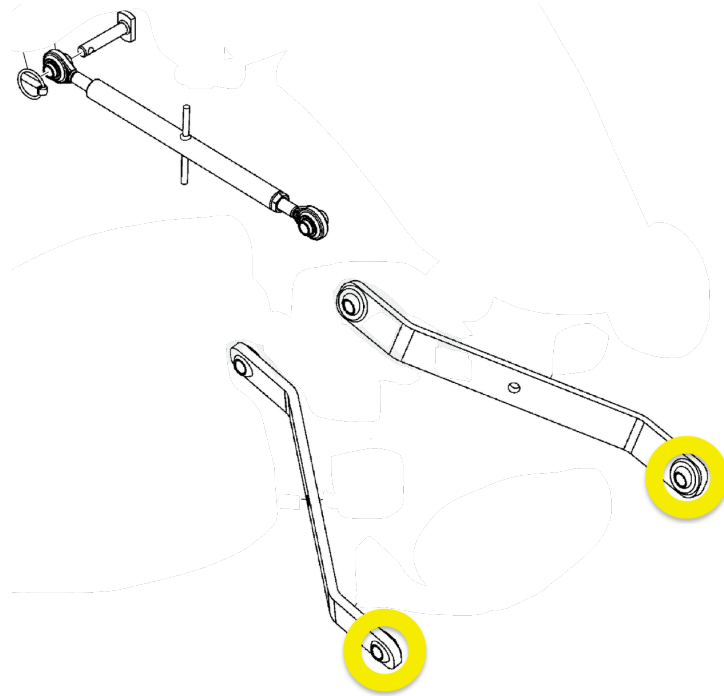

Step 2: Attach Mounting Arms to CheckMate™ Striping Roller

Using 1/2" x 1" bolts, attach mounting arms to the rectangular channel nuts located inside the channel. The channel nuts slide up and down the rail to allow for infinite connection points. Center the striping roller behind the mower and tighten each mounting arm to the gray striping kit frame. Note that the 1/2" lock washers should be used on the top side of the L bracket in combination with the 1" bolt to secure the (2) mounting arms to the gray channel [Min. 90 lbs. Torque].

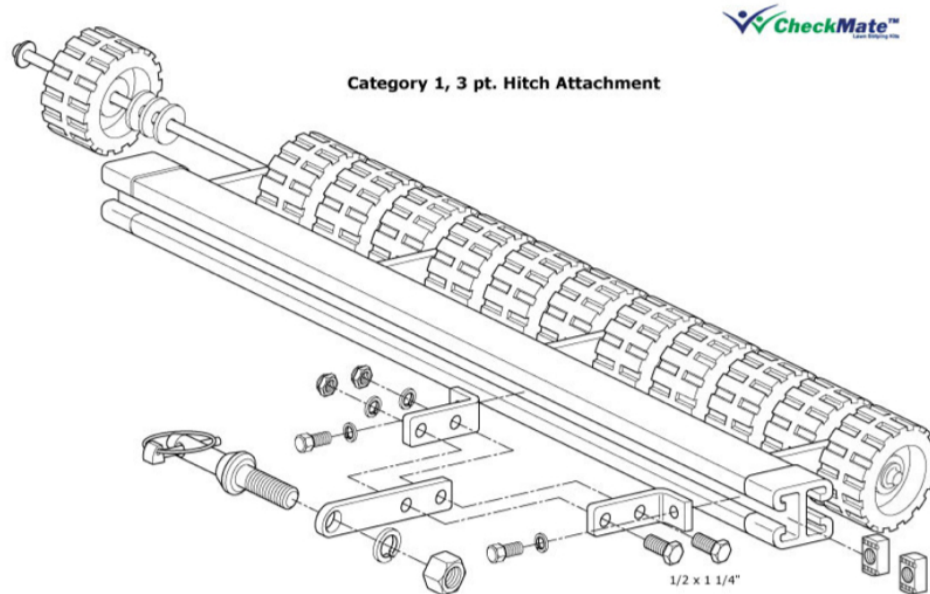

Step 3: Remove Quick Release Lynch Pins and Slide Mounting Arms with Stabilizer Pins installed, into your 3-Point Hitch Holes. Reinstall Lynch Pins.

3-Point Hitch Install Example:

