



CheckMate™ Lawn and Athletic Field Striping Kits

1125 Mac Tech Dr C -



Lansing, MI 48906



800.411.0150

[www.bigleaguelawns.com](http://www.bigleaguelawns.com)



## CheckMate™ Kubota® W Walk-Behind Series Lawn Striping Kit Installation Guide

### Important

Big League Lawns, LLC warrants their products to be free of defects in material and workmanship. This warranty does not cover defects due directly or indirectly to misuse, abuse, normal wear and tear, failure to properly maintain the product or used for a purpose other than that for which it is intended. The duration of this warranty is expressly limited to one year parts and labor beginning from the date of delivery to the original customer.

The obligation of Big League Lawns, LLC is limited solely to the repair or replacement, at our option, at its factory or authorized repair agent of any part that should prove deficient. Purchaser must maintain the product under normal operating conditions at all times. Prior to operation, become familiar with the attachment and any disconnect features. This product is not intended to be used in a transport position or to be backed over curbs. When not in use, the product should be removed from the mower and transported in a safe manner. Failure to follow these instructions will void the warranty.



US Patent 6,962,039 B2, US Patent 6,993,894 B2

Congratulations on your new purchase! You are just steps away from creating a beautifully patterned lawn using your new CheckMate™ lawn striping roller. To ensure a long life of both your mower and roller, please be sure to follow the mounting recommendations within this packet.



If you should have any questions regarding the use of a particular mounting method, please do not hesitate to contact us at 800.411.0150 or via email at [sales@bigleaguelawns.com](mailto:sales@bigleaguelawns.com).

Important: If you purchased your striping kit through a 3<sup>rd</sup> party vendor and have any questions regarding your mounting options, please do not hesitate to contact us. We have a great wealth of knowledge, tips and tricks, which may be helpful. Unfortunately, when we receive purchase orders via 3<sup>rd</sup> party vendors we do not know in advance what mower the roller is being attached to.

Thank you,

Big League Lawns, LLC

**When Mowing Isn't Enough... Let it Roll!**

**US Patent 6,962,039 B2**

**US Patent 6,993,894 B2**

**FEIN 38-3198349**



US Patent 6,962,039 B2, US Patent 6,993,894 B2

## Mounting Option B

Important: Only the 3/8" threaded portion of your pivot bolt threads pass through the mower frame. If you are mounting to an oversize hole, please place a 3/8" flat washer on the pivot bolt threads to prevent the smooth portion of this bolt from passing through your frame.

**Scan the second QR code on the page included with your shipment to view a mounting arm installation tutorial.**

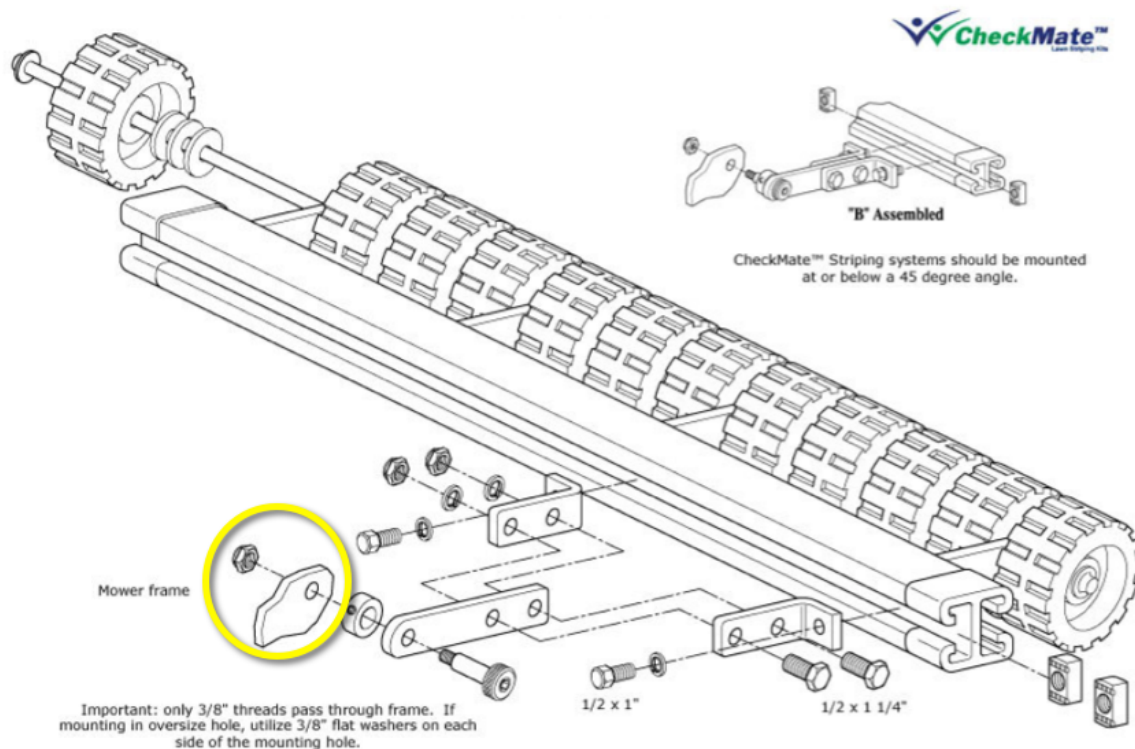



US Patent 6,962,039 B2, US Patent 6,993,894 B2

**Important:** Only the 3/8" threaded portion of the pivot bolt threads pass through your mower frame.

**DRILL:** Your 3/8" mounting holes will be drilled at the marked location on the schematic below (on each side of your mower).

**INSTALL:** Next, you will bolt your now assembled mounting arms to your mower frame.

It's best to install your mounting arms (seen in the Mounting Option B section of this packet) to your frame prior to connecting them to your striping rollers gray channel/cross member. This will make installation much easier as you will know exactly how wide your arms need to be installed onto your striper, in addition, you won't be fighting the weight of the striper throughout the process.

Once fully installed, simply lift your striper up to make sure it isn't impeded in anyway.

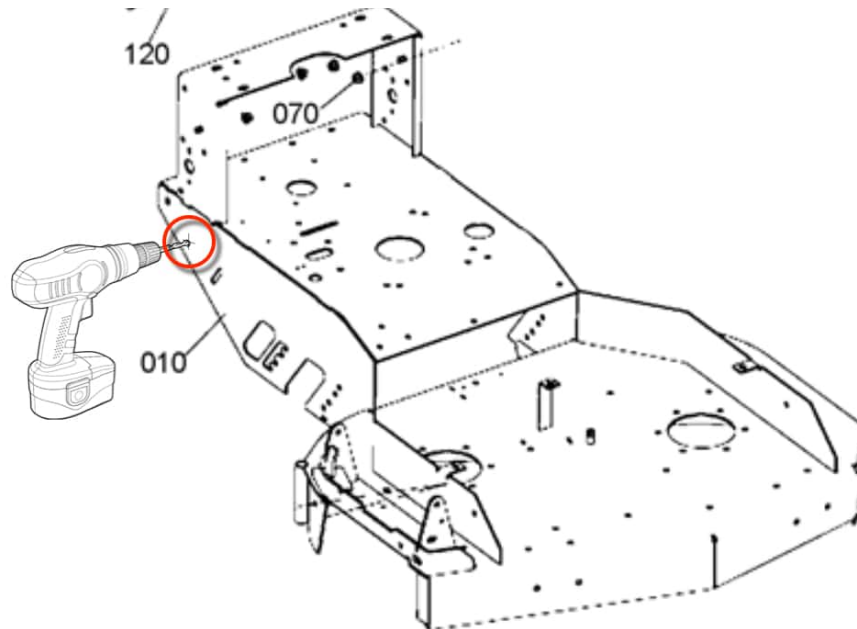

**Installation is now complete! Enjoy your striping with your new CheckMate™ Striping kit!**