



Country Clipper® Striping Kit Mounting Instructions

Boulevard



Boss XL



Important

Big League Lawns, LLC warrants their products to be free of defects in material and workmanship. This warranty does not cover defects due directly or indirectly to misuse, abuse, normal wear and tear, failure to properly maintain the product or used for a purpose other than that for which it is intended. The duration of this warranty is expressly limited to one year parts and labor beginning from the date of delivery to the original customer.

The obligation of Big League Lawns, LLC is limited solely to the repair or replacement, at our option, at its factory or authorized repair agent of any part that should prove deficient. Purchaser must maintain the product under normal operating conditions at all times. Prior to operation, become familiar with the attachment and any disconnect features. This product is not intended to be used in a transport position or to be backed over curbs. When not in use, the product should be removed from the mower and transported in a safe manner. Failure to follow these instructions will void the warranty.

Avenue, Boulevard, XLT, Challenger

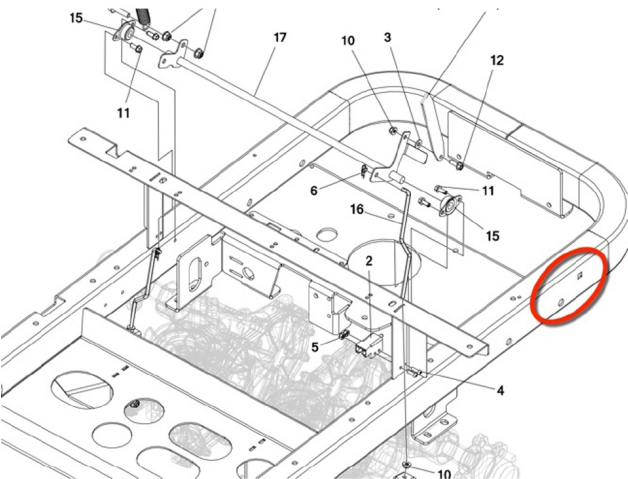

- Step 1:**
Locate existing holes at the rear of the mower mainframe (as noted on the picture).
- Step 2:**
Align holes of checkMate™ mounting bracket with the holes in the mower mainframe.

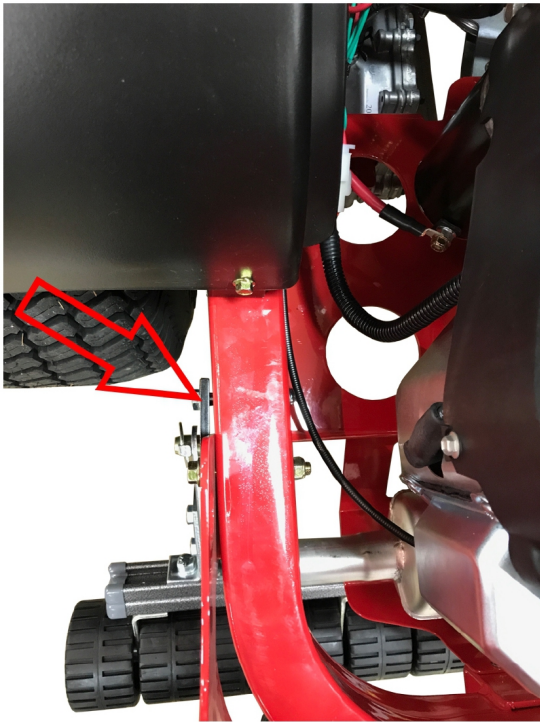

- Step 4:**
Confirm that both quick release stabilizer pins are pointing in the same direction for quick release application.
- Step 5:**
Place one 3/8" flat washer on supplied 3/8" x 3" bolts.
- Step 6:**
Install 3/8" x 3" bolts through the CheckMate™ mounting bracket, engine guard, and mower mainframe. Make sure to use 3/8" spacer to account for the engine guard gap (see picture).
- Step 7:**
Secure engine guard, and checkmate mounting bracket in place by threading the supplied 3/8" locknut onto the 3/8" x 3" bolts and tightening down. [Minimum 90lbs. Torque]

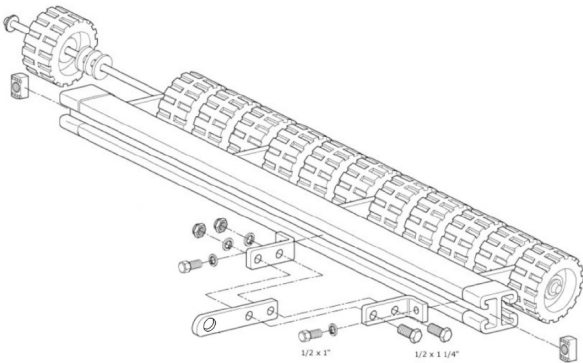

- Step 8:**
Pull 7/16" lynch pins from stabilizer pins
- Step 9:**
Slide CheckMate™ mounting arms onto stabilizer pins and replace lynch pins
- Step 10:**
Using (4) 1/2" x 1" hex bolts, attach mounting arms to striping kit frame [finger tight]
- Step 11:**
Center roller behind the machine and tighten mounting arms to gray striping kit frame [min. 90 lbs. Torque]

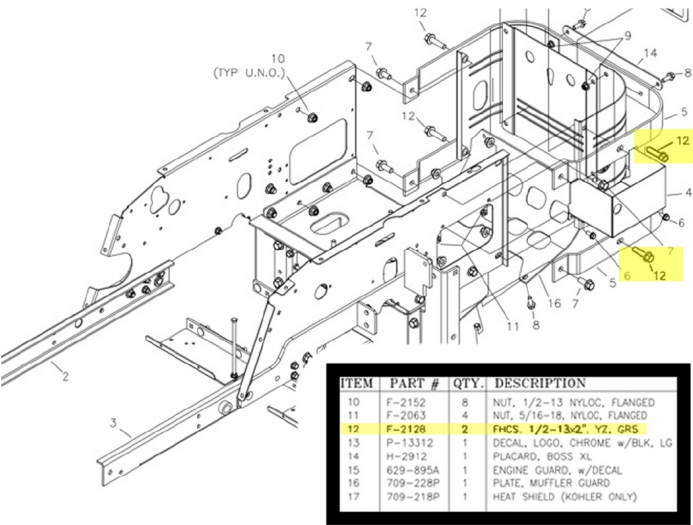

- Step 1:**
Remove #12 (1/2" - 13 x 2") bolts from the frame of the machine.



- Step 2:**
Confirm that both quick release stabilizer pins are pointing in the same direction for the quick release application.

- Step 3:**
Align holes in CheckMate™ mounting plate with exposed holes in the mower frame from the removed bolts. Reinstall #12(1/2" - 13 x 2") bolts and tighten to secure plate to the mower mainframe.

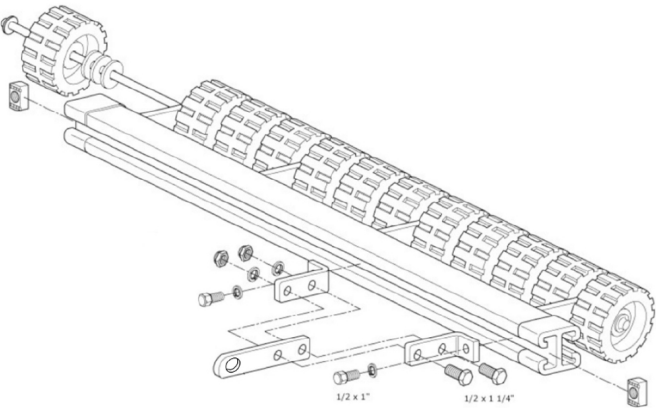

- Step 4:**
Pull 7/16" lynch pins from stabilizer pins
- Step 5:**
Slide CheckMate™ mounting arms onto stabilizer pins and replace lynch pins
- Step 6:**
Using (4) 1/2" x 1" hex bolts, attach mounting arms to striping kit frame [finger tight]
- Step 7:**
Center roller behind the machine and tighten mounting arms to gray striping kit frame [min. 90 lbs. Torque]